

# LS-PGY150C 150W LED HIGH BAY



150W LED high bay fixture with over 21,000 lumens. Reduces energy consumption by up to 70%. Ideal for large spaces, including warehouses, gymnasiums, and distribution centers.

Color: White

Weight: 6kgs

Project:

Type:

Prepared By:

Date:

## Driver Info

Type: Constant Current  
120V: A  
208V: A  
240V: A  
277V: A Input  
Watts: 150W  
Efficiency: 93%

## LED Info

Watts: 150W  
Color Temp: 6000K (Cool)  
Color Accuracy: 80 CRI  
L70 Lifespan: 100000  
Lumens: 21,000  
Efficacy: \* LPW

## Technical Specifications

### Listings

#### 3C Listing:

Suitable for damp locations with cord and hook.  
Suitable for wet locations with pendant stem.

#### IESNA LM-79 & LM-80 Testing:

RAB LED luminaires have been tested by an independent laboratory in accordance with IESNA LM-79 and LM-80, and have received the Department of Energy "Lighting Facts" label.

### LED Characteristics

#### LEDs:

LUMILUEDS chip, high-output, long-life LEDs

#### Lifespan:

100,000-hour LED lifespan based on IES LM-80 results and TM-21 calculations

#### Color Consistency:

Original Aluminum Color

#### Color Stability:

LED color temperature is warrantied to shift no more than 200K in CCT over a 5 year period.

#### Color Uniformity:

RAYSHOW's range of CCT (Correlated Color Temperature) follows the guidelines of the American National Standard for Specifications for the Chromaticity of Solid State Lighting (SSL) Products, ANSI C78.377-2011.

### Electrical

#### Drivers:

INVERTRONICS, Constant Current, 700mA, Class 2 with 6 kV surge protection, 100-277VAC, 50/60 Hz

#### Power Factor:

99.5% at 120V, 91.1% at 277V

#### THD:

8.2% at 120V, 11.3% at 277V

### Construction

#### Ambient Temperature:

Suitable for use in 55°C (131°F)

#### Thermal Management:

Superior heat sinking with external Air-Flow fins

#### Housing:

Extrusion aluminum housing and door frame with 3-foot 600V power core

#### Mounting:

Heavy-duty hook and 3-foot safety chain; is also 3/4" pendant mount-capable (pendant by others).

#### Recommended Mounting Height:

30 ft (10meter).

### Lens:

Tempered glass

### Reflector:

Specular vacuum metallized aluminum

### Gaskets:

High-temperature silicone

### Finish:

Our environmentally friendly polyester powder coatings are formulated for high-durability and long-lasting color, and contain no VOC or toxic heavy metals.

### Green Technology:

Mercury and UV free, and RoHS compliant. Polyester powder coat finish formulated without the use of VOC or toxic heavy metals.

### Other

#### Equivalency:

LS-PGY150C replaces 400W Watt metal halide.

#### Others:

Any additional component requirements will be listed under technical specifications on the product page.

# LS-PGY150C 150W LED HIGH BAY

## Dimensions

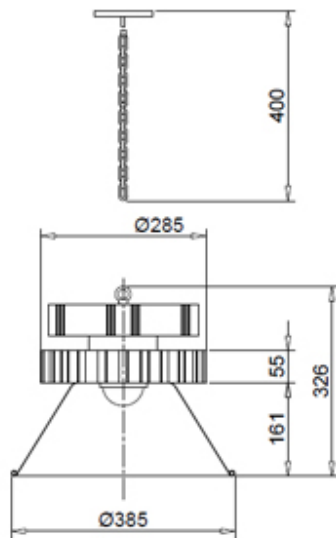

## Features

- High output, high efficiency LED high bay
- Bi-level and dimming models available when installed with pendant by others
- Poly-shield and wire guard accessories available for additional protection
- 100,000 hour lifespan
- 5-year no compromise warranty

## Ordering Matrix

Family	Watts	Color Temp	Finish	Dimming	Driver
LED HIGH BAY	PGY = CHIP LUMILEDS/ HIGH BAY 150 = 150W	= 6000K (Cool) Y = 3000K (Warm) N = 4000K (Neutral)	W = White	= No Dimming /D10 = Dimmable /PWM = Dimmable	A = MEANWELL B = OTHER C = INVERTRONICS D = PHILIPS