

LS-PGY300C 300W LED HIGH BAY



300W LED high bay fixture with over 39,000 lumens. Reduces energy consumption by up to 70%. Ideal for large spaces, including warehouses, gymnasiums, and distribution centers.

Color: White

Weight: 10kgs

Project:

Type:

Prepared By:

Date:

Driver Info

Type: Constant Current
120V: A
208V: A
240V: A
277V: A Input
Watts: 300W
Efficiency: 93%

LED Info

Watts: 300W
Color Temp: 6000K (Cool)
Color Accuracy: 80 CRI
L70 Lifespan: 100000
Lumens: 39,000
Efficacy: * LPW

Technical Specifications

Listings

3C Listing:

Suitable for damp locations with cord and hook.
Suitable for wet locations with pendant stem.

IESNA LM-79 & LM-80 Testing:

RAB LED luminaires have been tested by an independent laboratory in accordance with IESNA LM-79 and LM-80, and have received the Department of Energy "Lighting Facts" label.

LED Characteristics

LEDs:

LUMILUEDS chip, high-output, long-life LEDs

Lifespan:

100,000-hour LED lifespan based on IES LM-80 results and TM-21 calculations

Color Consistency:

Original Aluminum Color

Color Stability:

LED color temperature is warranted to shift no more than 200K in CCT over a 5 year period.

Color Uniformity:

RAYSHOW's range of CCT (Correlated Color Temperature) follows the guidelines of the American National Standard for Specifications for the Chromaticity of Solid State Lighting (SSL) Products, ANSI C78.377-2011.

Electrical

Drivers:

INVERTRONICS, Constant Current, 1400mA, Class 2 with 6 kV surge protection, 100-277VAC, 50/60 Hz

Power Factor:

99.5% at 120V, 91.1% at 277V

THD:

8.2% at 120V, 11.3% at 277V

Construction

Ambient Temperature:

Suitable for use in 55°C (131°F)

Thermal Management:

Superior heat sinking with external Air-Flow fins

Housing:

Extrusion aluminum housing and door frame with 3-foot 600V power core

Mounting:

Heavy-duty hook and 3-foot safety chain; is also 3/4" pendant mount-capable (pendant by others).

Recommended Mounting Height:

30 ft (10meter).

Lens:

Tempered glass

Reflector:

Specular vacuum metallized aluminum

Gaskets:

High-temperature silicone

Finish:

Our environmentally friendly polyester powder coatings are formulated for high-durability and long-lasting color, and contain no VOC or toxic heavy metals.

Green Technology:

Mercury and UV free, and RoHS compliant. Polyester powder coat finish formulated without the use of VOC or toxic heavy metals.

Other

Equivalency:

LS-PGY300C replaces 1000W Watt metal halide.

Others:

Any additional component requirements will be listed under technical specifications on the product page.

LS-PGY300C 300W LED HIGH BAY

Dimensions

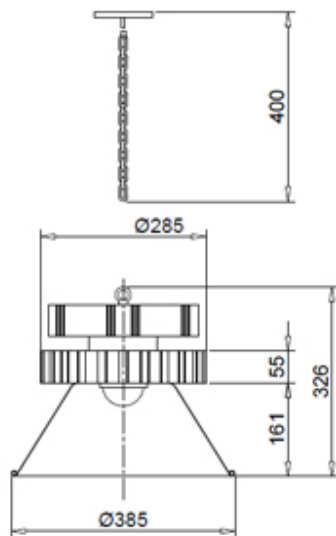

Features

- High output, high efficiency LED high bay
- Bi-level and dimming models available when installed with pendant by others
- Poly-shield and wire guard accessories available for additional protection
- 100,000 hour lifespan
- 5-year no compromise warranty

Ordering Matrix

Family	Watts	Color Temp	Finish	Dimming	Driver
LED HIGH BAY	PGY = CHIP LUMILEDS/ HIGH BAY 300 = 300W	= 6000K (Cool) Y = 3000K (Warm) N = 4000K (Neutral)	W = White	= No Dimming /D10 = Dimmable /PWM = Dimmable	A = MEANWELL B = OTHER C = INVERTRONICS D = PHILIPS